

---

# Teeth Whitening Light



## User Guide

# CONTENT

1.DESCRPTION-----	2
2.FEATURES-----	2
3.INSTALLATION-----	3
4.OPERATION-----	4
5.TECHNICAL PARAMETERS-----	6
6.PRECAUTION-----	6
7.MAINTENANCE-----	6
8.TRANPORTATION AND STORAGE-----	7
9.MALFUNCTION AND SOLVING METHOD-----	8
10.WARRANTY REGISTRATION FORM-----	9

# 1.DESCRPTION

The whitening device D6GG is a new type whitening Technology, based on the condition of **Strong** blue LED light and whitening kit accelerant. By the character of nanometerpellet on the surface and light decomposition, activate the most H<sub>2</sub>O<sub>2</sub> in short order on low or normal temperature. Produce mass oxygen atomy permeate teeth and decompose color molecule, to meet the effect of teeth whitening.

# 2.FEATURES

- (1). The specifical wavelength and high density light speed Catalyze whitening gel.
- (2). 6 powerful LED tubes emit a high intensive cold blue light
- (3). Special design, innocuous silica gel muzzle, make sure stopping intersectional infection.
- (4). The new model of power supply make sure steady power output and long-time continuous working even in some cities and places with mutative voltage.
- (5). Time display screen shows the whitening time clearly to both dentist and patient.

# 3.INSTALLATION

- (1)Main Body
- (2)Standing Bar
- (3)Up/Down Wheel Base
- (4)Mouth Guard
- (5)Wrench
- (6)Power Supply
- (7)Plastic Connector

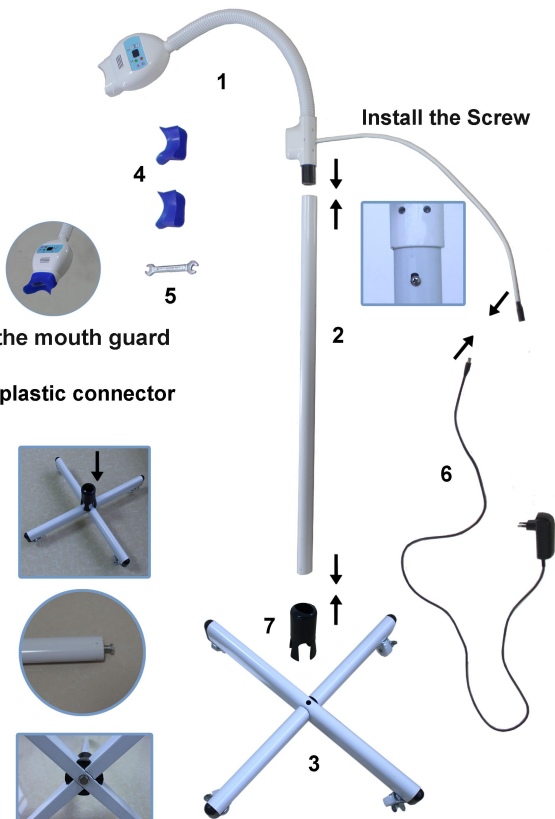

Install the mouth guard

Combine the base with the plastic connector

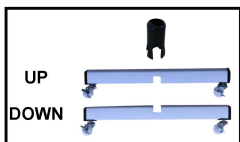

Loosen the screw  
in the stand bar



Install the screw  
to connect the stand bar,  
plastic connector and the base



## 4.OPERATION



### 4.1.Button Operation

- (1). ON/OFF : Press ON/OFF button to set the unit working. The power light and standby light on.
- (2). Time Setting (UP/DOWN): According to patient's condition,doctor can increase or decrease the time level from 1~20mins.
- (3). PAUSE: Press this button to set the unit to h-i standby mode. Ready indicator light is off, and standby indicator light is on.
- (4). START: Press this button to set the unit to send LED-luminescence
- (5). HIGH/LOW: Press this button to chiise light intensity as high mode or low mode

## **4.2 Application**

- (1). Connect power source and turn it on.
- (2). The machine is in stand-by after a prompt sound of buzzing. Position “ON/OFF” would be showed glinting “20”.
- (3). Adjust the operation time by “time up/ time down”, adjust range from 1 to 20 minutes.
- (4). Alarm sound after pressing “START”, and a blue light transmitted from the light guide of terminal, time display is counting down.
- (5). Alarm sound for 5 seconds after countdown finished, blue light extinguish.

## **4.3 Operation Notice**

- (1). Please don't turn the poer OFF immediately once blue light extinguished, the machine will turn to heat-emiting and cooling condition according to preset procedure
- (2). Light guide terminal is made of the polyester material which is smooth and transparent. Please do not clean it with the incisive object.
- (3). Please don't put heavy item on the power cable, and always keep the device far from heat source.
- (4). Turn it off without using it.

## **5. TECHNICAL PARAMETERS**

- (1). Power Supply: AC100-240V, 50/60HZ
- (2). Light Size: 33\*74mm<sup>2</sup>
- (3). Light Timing: 0~20 mins
- (4). Power Instability: < 1%
- (5). Working Method: time output & continuous working
- (6). Coupling: polyester monowave

## **6. PRECAUTION**

- (1). User should wear goggle during operation of the device.
- (2). Always keep treatment room ventilated during operation of the device.

## **7. MAINTENANCE**

- (1). Make regular back-check and keep machine surface clean.
- (2). This machine is precise optical equipment, it should be used in the clean and dry place without atomy.
- (3). Environment condition: no atomy, no shock, no dampness.
- (4). Treatment room temperature 16-20°C, humidity <40%
- (5). Clean up transparent head after each treatment by alcohol (avoid clean by sharp object), make sure it's clean to avoid cross infection between patients. Silica gel muzzle can be Sterilized.

- (6). If any “error” show on the display, turn off power and stop operating immediately, ask for help pr advice from professional technician.
- (7).Change the warter or sand inside the base regularly.

## **8.TRANSPORTATION AND STORAGE**

- (1).Lay lightly during transportation, avoid strong shake.
- (2). Storage condition:
  - a. Ambiance temperature:  $-40\sim 50^{\circ}\text{C}$
  - b. Relative humidity:  $<95\%$



# 9.MALFUNCTION AND SOLVING METHOD

No.	MALFUNCTION	RESOLVE
1	Turn on the machine, no working	a. Check if the power connect well b. Power is in bad condition, contact with supplier for help and advice
2	Light out putport without voltage	a. Power is in bad condition, contact with supplier
3	Light output power decline	a. Cross section of LED bulb is damaged b. LED bulb life expired, contact with supplier to exchange new one
4	Light output port with voltage, but without light output	a. LED bulb is amaged, contact with supplier to exchange new one.

# 10. WARRANTY REGISTRATION FORM

Item Name: \_\_\_\_\_

Model Name: \_\_\_\_\_

Serial No.: \_\_\_\_\_

Date of Purchase: \_\_\_\_\_

Name: \_\_\_\_\_

Address: \_\_\_\_\_

\_\_\_\_\_

\_\_\_\_\_

Phone: \_\_\_\_\_

Email: \_\_\_\_\_

Name of Distributor: \_\_\_\_\_

Authorized Distributors: \_\_\_\_\_

Stamp and Signature